

10 ROGERS STREET, CAMBRIDGE MA UNIT 430

MAIN FLOOR

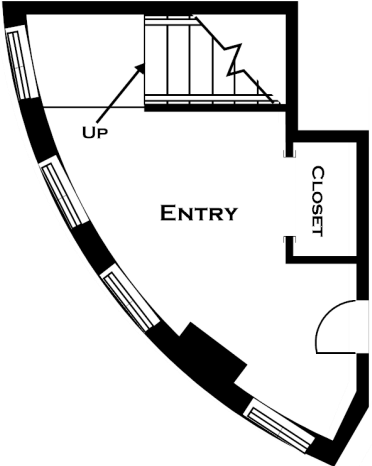

ENTRY FLOOR



ALL MEASUREMENTS ARE APPROXIMATE AND FOR INFORMATIONAL PURPOSES ONLY - NOT DRAWN TO SCALE
COPYRIGHT © 2022 BY DORENE HIGGONS

DORENE J HIGGONS
GRAPHICS/CONSULTING
781.724.7306
DORENE.HIGGONS@GMAIL.COM